

Project Name:	Part Number:	Type:
---------------	--------------	-------

FZ LOW PROFILE STRIP

COMMERCIAL



407-478-3759
www.ilp-inc.com



FEATURES

- Durable steel construction
- Frosted acrylic lens available
- 4ft & 8ft options available
- Multiple dimming & sensor options to fully control occupied & unoccupied light levels
- 3000K, 3500K, 4000K, and 5000K CCT
- 120-277V Universal Voltage
- 0-10V Dimmable Driver (100% - 10%)
- Single (4ft) or dual pendant (4ft & 8ft), surface mount and cable hanging options
- L90>54,000 hrs
- 5 Year Warranty
- ETL Listed for Dry and Damp Location
- DesignLights Consortium® Premium Qualified Luminaire



SUITABLE APPLICATIONS

- Schools
- Warehouses or Distribution Centers
- Grocery Stores
- Manufacturing Plants
- Retail Applications
- Stairwells (w/ USB Sensor) (4ft only)

EasySense Available on 4ft & 8ft

LED INFO		20W	32W	40W	55W		40W	64W	80W	110W
Calculated L ₇₀ (TM-21) Hours	4FT	>100K	>100K	>100K	>100K	8FT	>100K	>100K	>100K	>100K
Delivered Lumens		3,635 lm	5,241 lm	6,819 lm	8,626 lm		7,057 lm	10,521 lm	13,783 lm	17,128 lm
Total Input Watts		22 W	33 W	41 W	54 W		44 W	64W	82 W	108 W
Luminaire Efficacy Rating (LER)		163 lm/W	162 lm/W	168 lm/W	159 lm/W		161 lm/W	164 lm/W	169 lm/W	159 lm/W
Correlated Color Temperature (CCT)		4000K	4000K	4000K	4000K		4000K	4000K	4000K	4000K
Color Rendering Index (CRI)		>80	>80	>80	>80		>80	>80	>80	>80
Ambient Temperature Range		-4° F - 120° F	-4° F - 103° F	-4° F - 101° F	-4° F - 100° F		-4° F - 100° F	-4° F - 100° F	-4° F - 103° F	-4° F - 107° F

LED System data for Frosted Lens is located on the second page. LED System data above based on FZ4-20W-U-40, FZ4-32W-U-40, FZ4-40W-U-40, FZ4-55W-U-40, FZ8-40W-U-40, FZ8-64W-U-40, FZ8-80W-U-40, and FZ4-110W-U-40. LED Lumen Maintenance Estimates based on TM-21 projections for the light source at 25° C ambient.

ORDERING GUIDE:

Series	Watts	Driver	Color	Options	
FZ4 Low Profile Strip 4ft	20W	U 120-277 V Driver	50	FRAL	Frosted Acrylic Lens
	32W		40	ES	EasySense Control
	40W		35	ES/WWS/DR	EasySense Dual Rocker Wireless Wall Switch
	55W		30	ES/PCD	Pre-Installed App on Control Device for Commissioning
FZ8 Low Profile Strip 8ft	40W 64W 80W 110W			SR	Sensor Ready Driver
				DR	DALI-Ready Driver
				VDO[‡]	Lutron Vive DFCSJ-OEM-OCC (Daylight & Occupancy)
				VRF[†]	Lutron Vive DFCSJ-OEM-RF (RF Only)
				BLD	Bi-level dimming driver (Controlled via 2 hot heads)
				USBD	User Bi-Level Dim Sensor w/ Occ. Sensor
				BDxx	Preset Bi-Level Dim Sensor (xx=%eg.20,30)
				BDxxPC	Preset Bi-level Dim Sensor w/ Photocell
				DHPC	Daylight Harvesting (End Mounted)
				FIOS	On/Off Occupancy Sensor Installed
				WC*	11 GA Wire Cage
				RACEWAY/3WIRE[‡]	3 Wire Raceway Wiring Harness for Continuous Wiring Through Fixture
				RACEWAY/5WIRE[‡]	5 Wire Raceway Wiring Harness for Continuous Wiring Through Fixture
				VC	V-Clips
				HUB 3/4	3/4" Conduit HUB (1 per 4ft section)
				FMB**	Fixture Mounting Box (Use with HUB for single point mounting)
	HB-XX-18Y-PAD	Y-Toggle Cable System (xx = in)			
	ALBR	Alignment Bracket (Used to align fixtures mounted in continuous rows)			
	QMBR	Quick Mount Bracket for Surface Mounting (Set of 2)			
	FI/ILBCP07	7W LED Factory Installed Battery Backup			
	FI/ILBCP10	10W LED Factory Installed Battery Backup			
	FI/ILBCP12	12W LED Factory Installed Battery Backup			
	SD480*	480V Step Down Transformer			

* Option not DLC Listed

**Available for 4ft only

† Used only when mounting fixtures in continuous rows

‡ Must be used with SR Driver

FZ LOW PROFILE STRIP

COMMERCIAL

FROSTED LEN INFO		20W FRAL	32W FRAL	40W FRAL	55W FRAL	40W FRAL	64W FRAL	80W FRAL	110W FRAL
4FT	Calculated L ₇₀ (TM-21) Hours	>100K	>100K	>100K	>100K	>100K	>100K	>100K	>100K
	Delivered Lumens	3,138 lm	4,386 lm	5,858 lm	7,399 lm	6,125 lm	9,016 lm	11,944 lm	14,820 lm
	Total Input Watts	22 W	33 W	40 W	54 W	44 W	65 W	82 W	108 W
	Luminaire Efficacy Rating (LER)	141 lm/W	135 lm/W	146 lm/W	137 lm/W	140 lm/W	138 lm/W	147 lm/W	138 lm/W
	Correlated Color Temperature (CCT)	4000K	4000K	4000K	4000K	4000K	4000K	4000K	4000K
	Color Rendering Index (CRI)	>80	>80	>80	>80	>80	>80	>80	>80
	Ambient Temperature Range	-4°F - 120°F	-4°F - 103°F	-4°F - 101°F	-4°F - 100°F	-4°F - 100°F	-4°F - 100°F	-4°F - 103°F	-4°F - 107°F
	8FT								
LED System data above based on RZ4-20W-U-40-FRAL, RZ4-32W-U-40-FRAL, RZ4-40W-U-40-FRAL, RZ4-55W-U-40-FRAL, RZ8-40W-U-40-FRAL, RZ8-64W-U-40-FRAL, RZ4-80W-U-40-FRAL, & RZ4-110W-U-40-FRAL. LED Lumen Maintenance Estimates based on TM-21 projections for the light source at 25°C ambient.									

LINE DRAWING

FZ4:

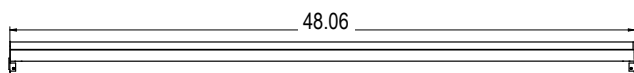
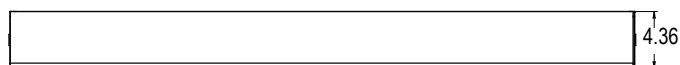

FZ8:

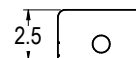
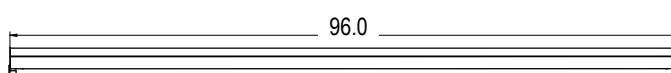

MOUNTING OPTIONS

- **V-Clips** - For dual point chain or cable hanging
- **HB-XX-18Y-PAD** - Y-Paddle Cables System (XX = in)
- **FMB** - Fixture Mounting Box (Use with HUB for single point mounting)
- **HUB 3/4 CONDUIT** - 3/4 Conduit HUB (1 per 4ft section)
- **ALBR** - Alignment Bracket (Used to align fixtures mounted in continuous rows)
- **QMBR** - Quick Mount Bracket for Surface Mounting (Set of (2))



V-CLIPS

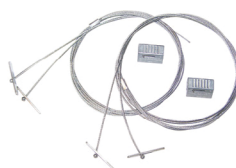

HB-XX-PAD

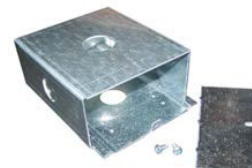

FMB



HUB 3/4 CONDUIT

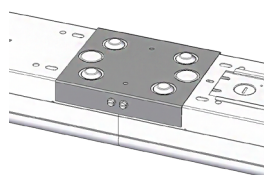

ALBR

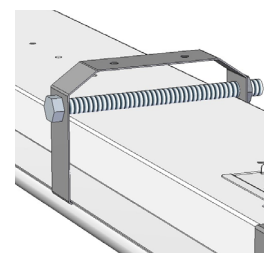

QMBR

FZ LOW PROFILE STRIP

COMMERCIAL

PHOTOMETRIC REPORTS

Photometric values based upon tests performed in compliance with LM-79. IES files can be downloaded at www.ilp-inc.com

FZ4-20WLED-U-40-FRAL

SUMMARY DATA

HEMISPHERES TESTED:	BOTH
EFFICIENCY (Downlight):	95.4%
EFFICIENCY (Uplight):	4.6%
CIE CLASSIFICATION:	DIRECT
LUMENS/LAMP:	3096.3
INPUT WATTS:	22.2415

PLANE AND CONE DIAGRAM

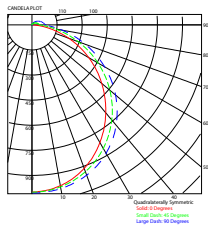

FZ4-32WLED-U-40-FRAL

SUMMARY DATA

HEMISPHERES TESTED:	BOTH
EFFICIENCY (Downlight):	95.8%
EFFICIENCY (Uplight):	4.2%
CIE CLASSIFICATION:	DIRECT
LUMENS/LAMP:	4268.636
INPUT WATTS:	32.4712

PLANE AND CONE DIAGRAM

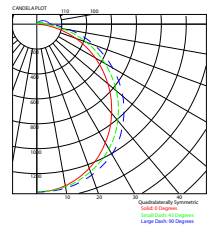

FZ4-40WLED-U-40-FRAL

SUMMARY DATA

HEMISPHERES TESTED:	BOTH
EFFICIENCY (Downlight):	95.9%
EFFICIENCY (Uplight):	4.1%
CIE CLASSIFICATION:	DIRECT
LUMENS/LAMP:	5879.027
INPUT WATTS:	40.62

PLANE AND CONE DIAGRAM

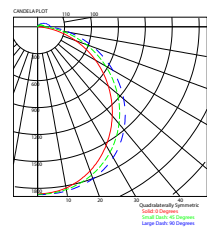

FZ4-55WLED-U-40-FRAL

SUMMARY DATA

HEMISPHERES TESTED:	BOTH
EFFICIENCY (Downlight):	94.9%
EFFICIENCY (Uplight):	5.1%
CIE CLASSIFICATION:	DIRECT
LUMENS/LAMP:	7314.931
INPUT WATTS:	53.9995

PLANE AND CONE DIAGRAM

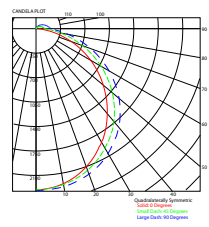

FZ8-40WLED-U-40-FRAL

SUMMARY DATA

HEMISPHERES TESTED:	BOTH
EFFICIENCY (Downlight):	95.3%
EFFICIENCY (Uplight):	4.7%
CIE CLASSIFICATION:	DIRECT
LUMENS/LAMP:	6215.038
INPUT WATTS:	43.7

PLANE AND CONE DIAGRAM

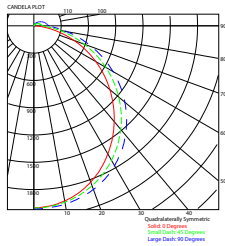

FZ8-64WLED-U-40-FRAL

SUMMARY DATA

HEMISPHERES TESTED:	BOTH
EFFICIENCY (Downlight):	95.6%
EFFICIENCY (Uplight):	4.4%
CIE CLASSIFICATION:	DIRECT
LUMENS/LAMP:	8583.105
INPUT WATTS:	64.03

PLANE AND CONE DIAGRAM

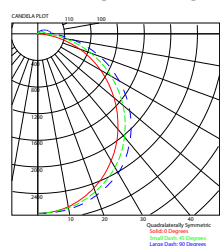

FZ8-80WLED-U-40-FRAL

SUMMARY DATA

HEMISPHERES TESTED:	BOTH
EFFICIENCY (Downlight):	95.9%
EFFICIENCY (Uplight):	4.1%
CIE CLASSIFICATION:	DIRECT
LUMENS/LAMP:	11763.04
INPUT WATTS:	81.5

PLANE AND CONE DIAGRAM

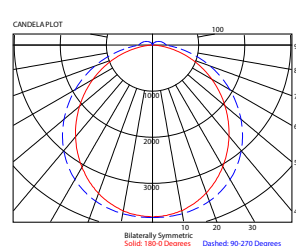

FZ8-110WLED-U-40-FRAL

SUMMARY DATA

HEMISPHERES TESTED:	BOTH
EFFICIENCY (Downlight):	94.7%
EFFICIENCY (Uplight):	5.3%
CIE CLASSIFICATION:	DIRECT
LUMENS/LAMP:	14694.39
INPUT WATTS:	107.8

PLANE AND CONE DIAGRAM

