

PREMIUM HIGH BAY INDUSTRIAL



407-478-3759
www.ilp-inc.com

FEATURES

- Premium efficiency delivers maximum savings
- Aluminum body with steel channel for added rigidity
- Tool-less hinged bottom ballast access door
- High gloss polyester white paint
- Riveted construction and vented ballast channel
- Clear Acrylic, Frosted Acrylic or Polycarbonate Lens options
- V-Clips for Dual Point Chain or Cable Hanging (std.)
- Multiple dimming & sensor options to fully control occ. & unocc. light levels
- 0-10V dimming driver
 - PHB - 50W / 105W / 126W / 210W (100% - 10%)
 - PHB - 76W / 84W / 157W / 168W / 252W / 336W / 495W / 660W (100% - 5%)
- ETL Listed for Damp Locations
- 5 Year Warranty



126W without a lens



126W with a frosted lens (LED info located on second page)



SUITABLE APPLICATIONS

- Gymnasium
- Warehouse
- Manufacturing Plants
- Distribution Centers

ORDERING GUIDE:

SERIES ¹	WATTS (Pick One)	DRIVER	CCT	LENS OPTIONS	
PHB Premium High Bay	50WLED	168WLED	UNIV 120-277V	50	BLANK No Lens
	76WLED	210WLED		40	FRL Frosted Acrylic Lens
	84WLED	252WLED		35	PCL Clear Polycarbonate Lens
	105WLED	336WLED		30	
	126WLED	495WLED			
	157WLED	660WLED			

OPTIONS	CONTROLS OPTIONS
Factory Installed	Basic
Cx Cord (x = ft) (x= 6,10,15,20)	FIOS ⁴ On/Off Occupancy Sensor
QDCx Quick Disconnect Cord (x = ft)	FIOSPC ⁴ On/Off Occupancy Sensor w/ Photocell
EM5 5W LED Factory Installed Battery Backup	FIOSPC/DLH ⁴ On/Off Occupancy Sensor w/ Daylight Harvesting
EM5/HE 5W LED Factory Installed Battery Backup - CEC Title 20 Compliant	DHPC ⁴ Daylight Harvesting
EM7 7W LED Factory Installed Battery Backup	USBD ⁴ User Bi-Level Dim Sensor w/ Occ. Sensor
EM7/HE 7W LED Factory Installed Battery Backup - CEC Title 20 Compliant	BDxx ⁴ Preset Bi-Level Dim Sensor (xx=%eg.20,30)
EM10 10W LED Factory Installed Battery Backup	BDxxPC ⁴ Preset Bi-level Dim Sensor w/ Photocell
EM10/HE 10W LED Factory Installed Battery Backup - CEC Title 20 Compliant	
EM12 12W LED Factory Installed Battery Backup	
EM20 ^{2,3} 20W LED Factory Installed Battery Backup - CEC Title 20 Compliant	
SD480 480V Step Down Transformer	
SD347 347V Step Down Transformer	
Ship With Accessories	Advanced
WC 11 GA Wire Cage	ESMC/HB ^{4,5} EasySense High Bay Sensor
FMB Fixture Mounting Box	OFD1Z ^{4,7} Leviton Drop Nipple Mount Bluetooth Groupable Sensor (16 Devices) with 8-20' & 20-40' lens included
HUB3/4 Conduit Hub 3/4" for pendant mount	
HOOK Cast Iron Hook for single point mounting	
ACxY Adjustable Y-Toggle aircraft cable set (x = 5' or 10')	
SMZBKIT Surface Mount Bracket	
ESMC/IR ⁶ EasySense Commissioning IR Blaster	

¹ Does not qualify for DLC

² Cannot be used with FMB, HUB or HOOK

³ Externally mounted to fixture

⁴ Sensor mounted off end cap of fixture

⁵ Easily Controlled via Mobile Phone with Philips MasterConnect Bluetooth App

⁶ Easily Controlled via Mobile Phone with Bluetooth App

⁷ Requires Bluetooth Compatible Device for additional programming (provided by others)

PREMIUM HIGH BAY

INDUSTRIAL

LED SYSTEMS INFO ¹	4000K		5000K		Watts ²	Replaces
	Part Numbers	Lumens	Efficacy	Lumens		
PHB-50WLED-UNIV-XX	7,405 lm	146 lm/w	7,511 lm	148 lm/w	51W	2T5HO
PHB-50WLED-UNIV-XX-FRL	6,406 lm	126 lm/w	6,498 lm	128 lm/w	51W	2T5HO
PHB-76WLED-UNIV-XX	11,892 lm	154 lm/w	11,900 lm	153 lm/w	77W	250W MH
PHB-76WLED-UNIV-XX-FRL	10,170 lm	132 lm/w	10,211 lm	131 lm/w	77W	250W MH
PHB-84WLED-UNIV-XX	13,836 lm	162 lm/w	14,036 lm	164 lm/w	85W	3T5HO
PHB-84WLED-UNIV-XX-FRL	11,910 lm	139 lm/w	11,993 lm	140 lm/w	85W	3T5HO
PHB-105WLED-UNIV-XX	15,239 lm	144 lm/w	15,920 lm	150 lm/w	104W	4T5HO
PHB-105WLED-UNIV-XX-FRL	13,140 lm	125 lm/w	13,727 lm	137 lm/w	104W	4T5HO
PHB-126WLED-UNIV-XX	20,153 lm	159 lm/w	20,444 lm	161 lm/w	127W	400W MH
PHB-126WLED-UNIV-XX-FRL	17,320 lm	137 lm/w	17,444 lm	137 lm/w	127W	400W MH
PHB-157WLED-UNIV-XX	24,821 lm	158 lm/w	25,179 lm	160 lm/w	157W	400W MH
PHB-157WLED-UNIV-XX-FRL	21,210 lm	135 lm/w	21,495 lm	136 lm/w	157W	400W MH
PHB-168WLED-UNIV-XX	27,240 lm	160 lm/w	27,730 lm	162 lm/w	170W	6T5HO
PHB-168WLED-UNIV-XX-FRL	23,225 lm	137 lm/w	23,560 lm	138 lm/w	170W	6T5HO
PHB-210WLED-UNIV-XX	34,050 lm	162 lm/w	34,070 lm	162 lm/w	210W	8T5HO
PHB-210WLED-UNIV-XX-FRL	29,510 lm	141 lm/w	29,640 lm	141 lm/w	210W	8T5HO
PHB-252WLED-UNIV-XX	40,240 lm	160 lm/w	40,820 lm	162 lm/w	251W	8T5HO
PHB-252WLED-UNIV-XX-FRL	34,840 lm	139 lm/w	35,342 lm	140 lm/w	251W	8T5HO
PHB-336WLED-UNIV-XX	54,717 lm	162 lm/w	55,505 lm	164 lm/w	338W	1000W MH
PHB-336WLED-UNIV-XX-FRL	46,190 lm	138 lm/w	47,171 lm	140 lm/w	338W	1000W MH
PHB-495WLED-UNIV-XX	73,828 lm	148 lm/w	74,800 lm	150 lm/w	498W	1000W MH
PHB-495WLED-UNIV-XX-FRL	62,150 lm	126 lm/w	62,930 lm	127 lm/w	498W	1000W MH
PHB-660WLED-UNIV-XX	96,000 lm	146 lm/w	97,264 lm	148 lm/w	659W	1000W MH
PHB-660WLED-UNIV-XX-FRL	87,780 lm	134 lm/w	88,936 lm	135 lm/w	659W	1000W MH

¹Values are nominal, see IES file for more detail
²Electrical data at 25C (77F). Actual wattage may differ by +/-10%.

SPECIFICATIONS

CONSTRUCTION

Aluminum body with steel driver channel for maximum rigidity and thermal properties. Sleek curved polycarbonate injection molded end caps provide a modern finish while adding rigidity and durability. Toolless hinged driver door access for ease of maintenance and installation. Power access plate mounted on back of center driver channel for easy access to wiring. Product proudly assembled in the United States of America.

ELECTRICAL

Class 2 LED light engine for high efficacy and long life. Calculated L70 > 100,000 hrs. LED Lumen Maintenance Estimates based on TM-21 projections for the light source at 25°C ambient. Power Factor > 0.90. Standard 120-277 Vac 0-10V dimmable (10%-100%) with optional 347-480 Vac step down transformer. Optional emergency battery backups and generator transfer device available to meet critical life safety lighting requirements. Fixture reduced maximum ambient for emergency battery backup and step down options. Optional uplight wired to sensor if ordered together.

MOUNTING

Options include suspension chain, aircraft cables, hook, single pendant (HUB), surface mount (SMZBKIT). Reduced maximum ambient range for surface mount.

WARRANTY

5 Year Warranty (Terms and Conditions apply)

OPTICS

Standard without lens. Optional frosted acrylic (FRL) and frosted polycarbonate (PFL) lenses available for added LED protection and glare reduction. Both optics are IP5X rated; protected against dust intrusion. Frosted Polycarbonate lens (PFL) is IK10 Impact Rated; highest impact rating available. Wide (std.) & Narrow (ND) Distribution options available for all lumen packages.

THERMAL

Ambient temperature range -40°F to 122°F (-40°C to 50°C). Fixture to be mounted at a minimum plenum height of 18" to maintain maximum ambient temperature. Reduced maximum ambient for surface mounting.

CONTROLS

Factory installed Advanced and Basic integral occupancy sensor options available. All Basic sensors are end mounted. Advanced EasySense sensor is end mounted. All other Advanced sensors are center driver cover mounted. Inquire with manufacturer for additional controls options, including customer supplied items.

CERTIFICATIONS

ETL listed to US and Canadian safety standards. Suitable for damp locations. American Recovery and Reinvestment Act Funding Compliant.

PREMIUM HIGH BAY INDUSTRIAL

CONTROLS OPTIONS

BASIC

FIOS

Standard on/off motion sensor. Comes with 360 degree high bay lens, 360 degree low bay lens & aisle lens. 360 degree high bay lens factory installed, unless notified otherwise. Sensor mounted off end cap of fixture. Inquire for mounting on center of driver cover.

FIOSPC

Motion sensor with the addition of photocell control. When installed, fixture will not activate unless 1. motion is detected and 2. light levels are below the preset level. When activated, fixture will turn on to 100% light output & will only shut off when one of the two levels mentioned above are met. If no motion is detected & light levels fall below preset level the fixture remains off. Sensor mounted off end cap of fixture.

FIOSPC/DLH

Factory installed motion sensor with the addition of photocell control that will allow for daylight harvesting. When installed, fixture will not activate unless 1. motion is detected & 2. light levels are below the preset level. When activated, fixture will turn on only enough to meet the preset light levels and will adjust as the amount of light in the space adjusts between 100%-10%. If light levels are adequate the fixture will remain off. Sensor mounted off end cap of fixture.

DHPC

Daylight Harvesting off photocell. Fixtures will continually dim up/down throughout the day based on light level readings taken from the photocell control. Sensor mounted off end cap of fixture.

USBD

User Selectable Bi-Level Dimming. Allows the end user to manually select the unoccupied dimming level. Once motion is detected, the fixture will return to 100% light output. Sensor mounted off end cap of fixture.

BDxx

Factory set Bi-Level Dimming. Sensor is set to dim level, as indicated in the "xx" portion of the part number, when the area is unoccupied. Example: BD20 sets the fixture to dim down to 20% lumen output when the area is unoccupied. Once motion is detected, the fixture will return to 100% light output. Sensor mounted off end cap of fixture.

BDxxPC

Factory set Bi-Level Dimming with motion and photocell. Sensor is set to dim level, as indicated in the "xx" portion of the part number, when the area is unoccupied and will not return to 100% light output unless 1. motion is detected and 2. the light level is below the preset level. Example: BD20PC sets the fixture to dim down to 20% lumen output when the area is unoccupied and will not return to 100% light output unless the above conditions are met for both motion and light level readings. Sensor mounted off end cap of fixture.

ADVANCED

Philips ESMC/HB

EasySense sensor combines occupancy sensing, daylight harvesting and institutional tuning in one compact solution. This is an ideal control for any high bay application. Each device allows you to turn on/off occupancy and/or daylight harvesting functions as well as set the full light output, background light level, occupancy prolong time, occupancy grace fading time & occupancy time out/hold time. Easily Controlled via Mobile Phone with Philips MasterConnect Bluetooth App. (Sold separately). Sensor mounted off end cap of fixture.

MOUNTING OPTIONS

- **V-Clips (std)** - For dual point chain or cable hanging
- **SMBKIT** - Surface Mount V-Clip Brackets with 2" space above fixture
- **FMB** - Fixture Mounting Box - Includes rigid box to attach to the fixture, provides for single point mounting to accept a pendant, hook or conduit hub (sold separately).
- **HUB 3/4 CONDUIT** - Conduit Hub 3/4"
- **HOOK** - Cast iron hook for single point mount
- **ACxY** - Adjustable Y-Toggle aircraft cable set (x = 5' or 10')



V-Clips (std.)



SMBKIT

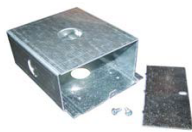

FMB



HUB 3/4 CONDUIT



HOOK

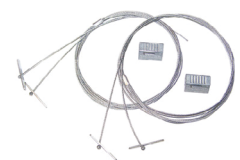

ACxY

PREMIUM HIGH BAY

INDUSTRIAL

LINE DRAWINGS

50W : Top View

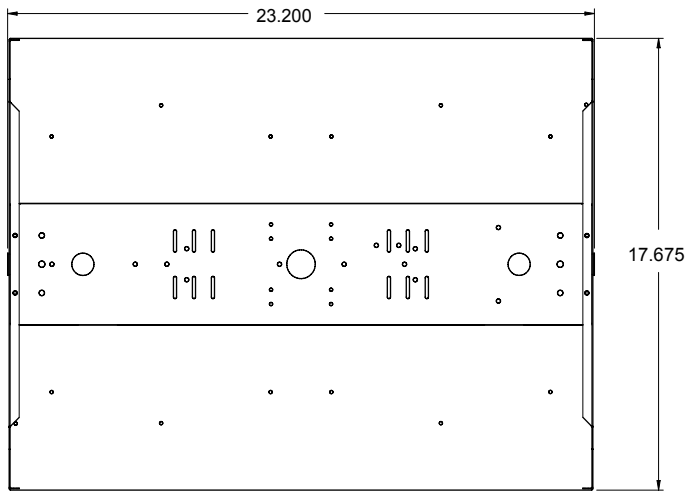

76W - 157W : Top View

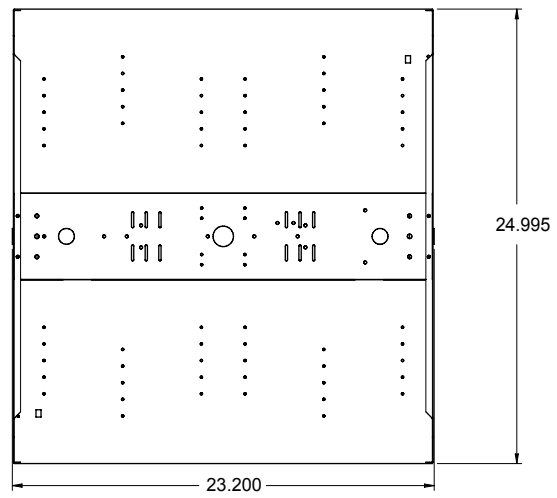

Side View

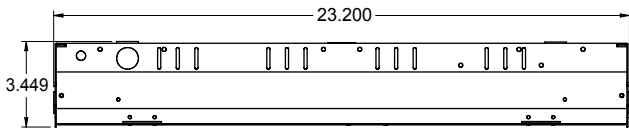

Side View

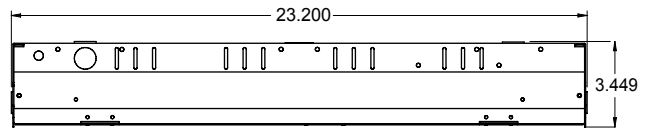

End View

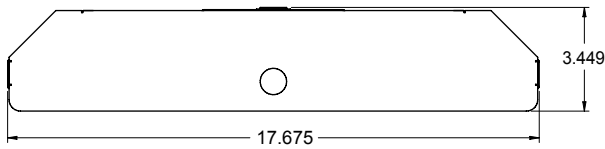

End View

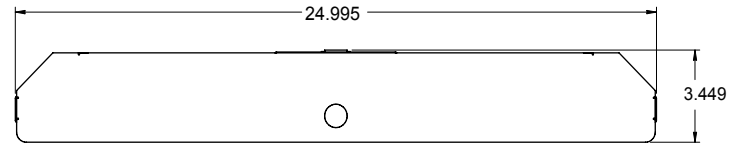

168W - 252W & 495W : Top View

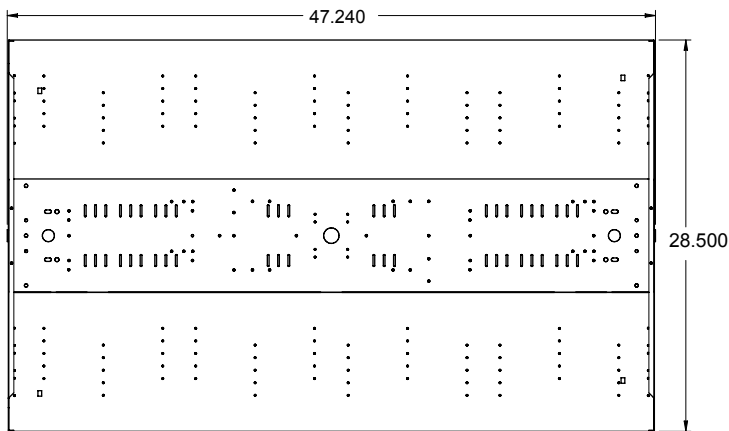

336W & 660W : Top View

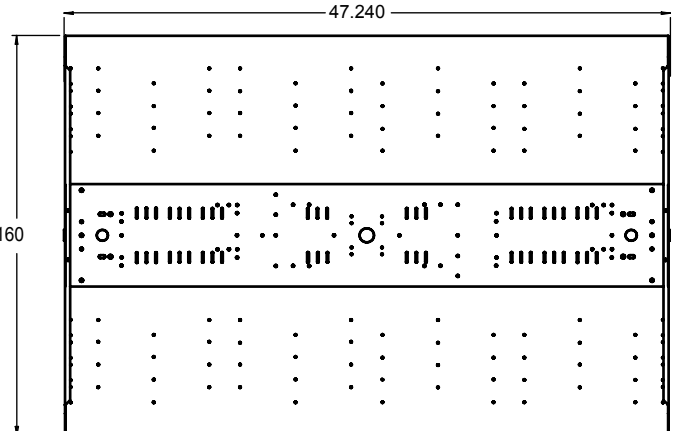

Side View

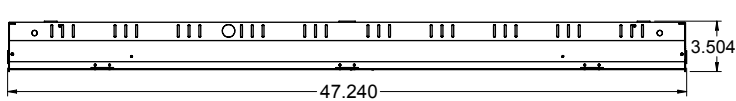

Side View

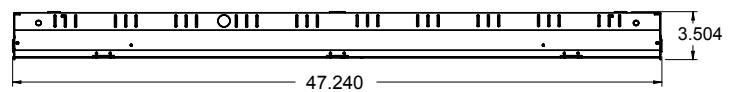

End View

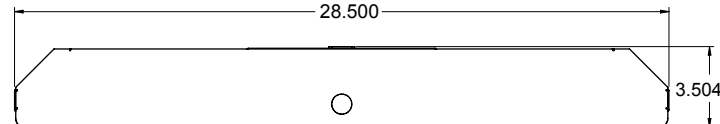

End View

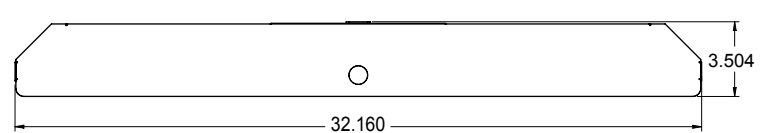

PREMIUM HIGH BAY

INDUSTRIAL

PHOTOMETRIC DATA

LUMINAIRE DATA	
Part Number	PHB-76WLED-UNIV-50
Description	Premium High Bay, 11,900lm, without lens
Fixture Lumens (lm)	11,900 lm
Wattage (W)	77 W
Efficacy (lm/W)	153 lm/W
Mounting	Pendant
Spacing Criteria	0° = 1.28, 90° = 1.31

ZONAL LUMEN SUMMARY		
Zone	Lumens (lm)	% Fixture
0° - 40°	5,276	46%
0° - 60°	9,466	82%
0° - 90°	11,517	100%
90° - 180°	3	0%
0° - 180°	11,520	100%

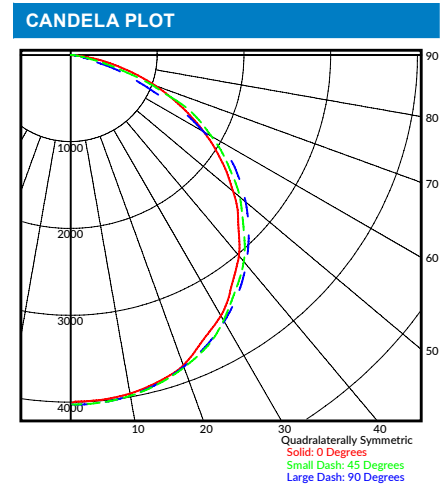

LUMINAIRE DATA	
Part Number	PHB-126WLED-UNIV-50
Description	Premium High Bay, 20,400lm, without lens
Fixture Lumens (lm)	20,444 lm
Wattage (W)	161 W
Efficacy (lm/W)	127 lm/W
Mounting	Pendant
Spacing Criteria	0° = 1.28, 90° = 1.31

ZONAL LUMEN SUMMARY		
Zone	Lumens (lm)	% Fixture
0° - 40°	8,777	45%
0° - 60°	15,770	82%
0° - 90°	19,269	100%
90° - 180°	43	0%
0° - 180°	19,311	100%

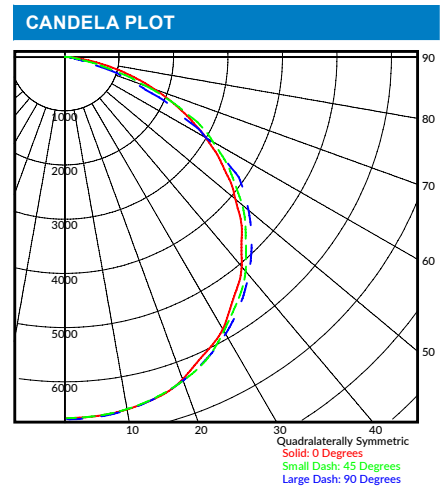

LUMINAIRE DATA	
Part Number	PHB-157WLED-UNIV-50
Description	Premium High Bay, 25,100lm, without lens
Fixture Lumens (lm)	25,179 lm
Wattage (W)	157 W
Efficacy (lm/W)	160 lm/W
Mounting	Pendant
Spacing Criteria	0° = 1.29, 90° = 1.31

ZONAL LUMEN SUMMARY		
Zone	Lumens (lm)	% Fixture
0° - 40°	10,819	45%
0° - 60°	19,441	82%
0° - 90°	23,731	100%
90° - 180°	53	0%
0° - 180°	23,784	100%

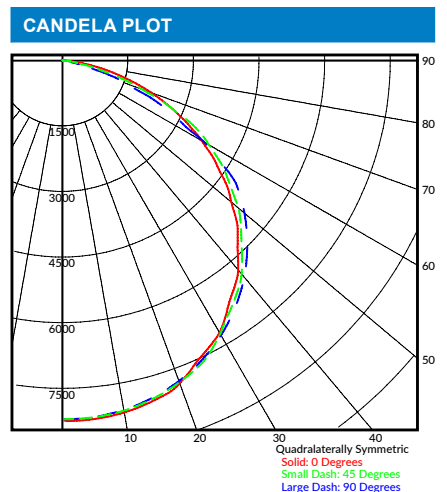

PREMIUM HIGH BAY

INDUSTRIAL

PHOTOMETRIC DATA

LUMINAIRE DATA	
Part Number	PHB-210WLED-UNIV-50
Description	Premium High Bay, 34,000 lm, without lens
Fixture Lumens (lm)	34,070 lm
Wattage (W)	210 W
Efficacy (lm/W)	162 lm/W
Mounting	Pendant
Spacing Criteria	0° = 1.31, 90° = 1.31

ZONAL LUMEN SUMMARY		
Zone	Lumens (lm)	% Fixture
0° - 40°	14,744	45%
0° - 60°	26,724	82%
0° - 90°	32,765	100%
90° - 180°	7	0%
0° - 180°	32,772	100%

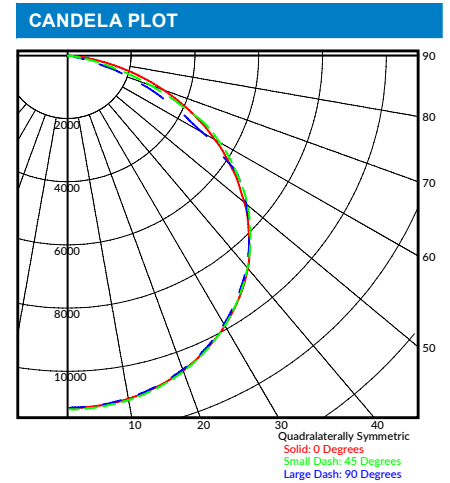

LUMINAIRE DATA	
Part Number	PHB-336WLED-UNIV-50
Description	Premium High Bay, 55,500 lm, without lens
Fixture Lumens (lm)	55,505 lm
Wattage (W)	338 W
Efficacy (lm/W)	164 lm/W
Mounting	Pendant
Spacing Criteria	0° = 1.33, 90° = 1.32

ZONAL LUMEN SUMMARY		
Zone	Lumens (lm)	% Fixture
0° - 40°	23,255	44%
0° - 60°	42,220	81%
0° - 90°	52,412	100%
90° - 180°	5	0%
0° - 180°	52,417	100%

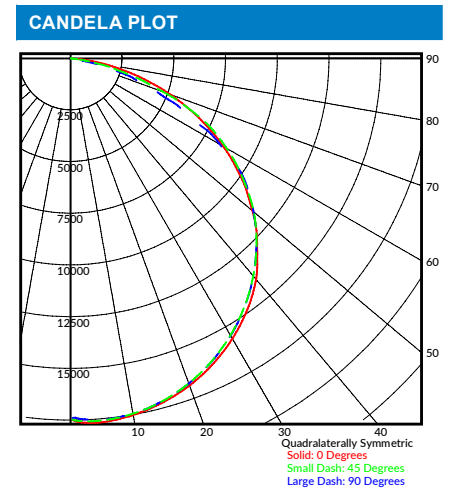

LUMINAIRE DATA	
Part Number	PHB-660WLED-UNIV-50
Description	Premium High Bay, 97,000 lm, without lens
Fixture Lumens (lm)	97,264 lm
Wattage (W)	659 W
Efficacy (lm/W)	148 lm/W
Mounting	Pendant
Spacing Criteria	0° = 1.33, 90° = 1.31

ZONAL LUMEN SUMMARY		
Zone	Lumens (lm)	% Fixture
0° - 40°	40,195	45%
0° - 60°	72,913	81%
0° - 90°	90,183	100%
90° - 180°	0	0%
0° - 180°	90,183	100%

